



# Quebec LED

## BRP776 LED30-4S/830 PSR DM50 FR BK D11 5

QUEBEC LED - LED module 3000 lm - 4th generation, screw fixation - 830 warm white - Power supply unit regulating - Safety class I (I) - Distribution medium 50 - Flat glass - Black - Philips standard surge protection level kV - - - 25 °C - -

Quebec LED is a stylish luminaire designed to brighten up residential streets and pathways, precincts, parks and other urban spaces. It incorporates an energy-efficient LED engine with high-performance optics, while at the same time retaining the character of the original Quebec fixture. It also offers a choice of bowl versions and mounting options. All these factors together make Quebec LED a versatile solution that can meet the needs of any project.

### Product data

General Information		Protection class IEC	Safety class I (I)
Lamp family code	LED30 [ LED module 3000 lm]	Flammability mark	NO [ - ]
Lamp version	4S [ 4th generation, screw fixation]	CE mark	CE mark
Light source colour	830 warm white	ENEC mark	ENEC mark
Light source replaceable	Yes	Warranty period	5 years
Number of gear units	1 unit	Optic type outdoor	Distribution medium 50
Driver/power unit/transformer	PSR [ Power supply unit regulating]	Remarks	*- According to the Lighting Europe guidance paper 'Evaluating performance of LED based luminaires – January 2018': statistically there is no relevant difference in lumen maintenance between the B50 and, for example, the B10. Therefore, the median useful life (B50) value also represents the B10 value. * At extreme ambient temperatures the luminaire might automatically dim down to protect components
Driver included	Yes		
Optical cover/lens type	FG [ Flat glass]		
Luminaire light beam spread	30° - 5° x 153°		
Control interface	Analog		
Connection	Plug-in connector 3-pole Wieland/Adels compatible and 2x 2-pole control signal for light regulation		
Cable	-		

# Quebec LED

Constant light output	No
Number of products on MCB (16 A type B)	20
EU RoHS compliant	Yes
Light source engine type	LED
Serviceability class	Class A, the luminaire is equipped with serviceable parts (when applicable): LED board, driver, control units, surge-protection device, optics, front cover and mechanical parts
Product family code	BRP776 [ QUEBEC LED]

## Light Technical

Upward light output ratio	0.03
Standard tilt angle post-top	-
Standard tilt angle side entry	0°

## Operating and Electrical

Input Voltage	220 to 240 V
Input frequency	50 to 60 Hz
Inrush current	22 A
Inrush time	0.29 ms
Power factor (min.)	0.97
Power factor (nom.)	0.92

## Controls and Dimming

Dimmable	Yes
----------	-----

## Mechanical and Housing

Housing material	Aluminum
Reflector material	-
Optic material	Polymethyl methacrylate
Optical cover/lens material	Glass
Fixation material	Aluminium
Mounting device	No [ -]
Optical cover/lens shape	Flat
Optical cover/lens finish	Frosted
Overall height	388 mm
Overall diameter	472 mm
Effective projected area	0.094 m <sup>2</sup>
Colour	Black
Dimensions (height x width x depth)	388 x NaN x NaN mm (15.3 x NaN x NaN in)

## Approval and Application

Ingress protection code	IP65 [ Dust penetration-protected, jet-proof]
Mech. impact protection code	IK08 [ 5 J vandal-protected]
Surge protection (common/differential)	Philips standard surge protection level kV

## Initial Performance (IEC Compliant)

Initial luminous flux	2520 lm
Luminous flux tolerance	+/-7%
Initial LED luminaire efficacy	107 lm/W
Init. Corr. Colour Temperature	3000 K
Init. Colour rendering index	>80
Initial chromaticity	(0.410, 0.390) SDCM <5
Initial input power	23.5 W
Power consumption tolerance	+/-11%

## Over Time Performance (IEC Compliant)

Control gear failure rate at median useful life 100,000 h	10 %
Lumen maintenance at median useful life* 100,000 h	94

## Application Conditions

Ambient temperature range	-40 to +50 °C
Performance ambient temperature Tq	25 °C
Maximum dimming level	25%

## Product Data

Full product code	871869908988700
Order product name	BRP776 LED30-4S/830 PSR DM50 FR BK D11 5
EAN/UPC – product	8718699089887
Order code	08988700
SAP numerator – quantity per pack	1
Numerator – packs per outer box	1
SAP material	912300023478
SAP net weight (piece)	6.175 kg



Dimensional drawing

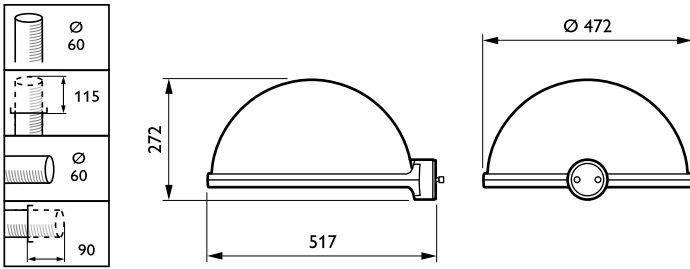

Quebec LED BRP775/776

Photometric data

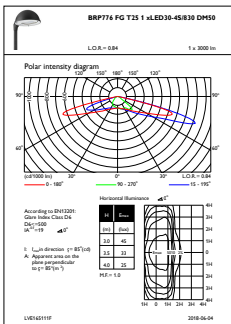

OFPL1\_BRP776FGT251xLED30-4S830DM50

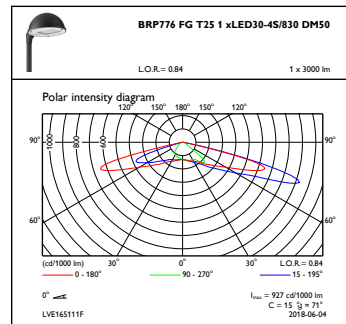

OFPC1\_BRP776FGT251xLED30-4S830DM50

