



HID ignitors for MK4 semi-parallel systems

SKD 578-S 220-240V 50/60Hz

HID ignitors for semi-parallel systems

Product data

General Information	
Application code	578-S
Lamp type	SON/CDM/MH/HPI/HPA/CDO
Number of lamps	1 piece/unit
Operating and Electrical	
Input Voltage	220 to 240 V
Input frequency	50 to 60 Hz
Ignition type	Semi-Parallel
Ignition attempts	3
Number of ignition pulses	1
Ignition time (max.)	1185 s
Ignition voltage (max.)	5.00 kV
Ignition voltage (min.)	1.80 kV
Response voltage	190 V
Mains voltage performance (AC)	-8%+6%
Mains voltage safety (AC)	-10%+10%
Power losses (nom.)	0.5 W
Wiring	
Wire strip length	6.0 mm
Ballast contact wire cross section	0.50-2.50 mm ²

Connector type	Screw
System characteristics	
Rated ballast-lamp power	35-600 W
Temperature	
T-ambient (max.)	85 °C
T-ambient (min.)	-30 °C
T storage (max.)	85 °C
T storage (min.)	-35 °C
T-Case maximum (max.)	90 °C
Approval and Application	
Approval marks	CE marking ENEC certificate
Product Data	
Full product code	872790089569800
Order product name	SKD 578-S 220-240V 50/60Hz
EAN/UPC – product	8711500881779
Order code	89569800
SAP numerator – quantity per pack	1
SAP numerator – packs per outer box	20
Material no. (12 NC)	913700655466

HID ignitors for MK4 semi-parallel systems

SAP net weight (piece)

31.400 g

Dimensional drawing

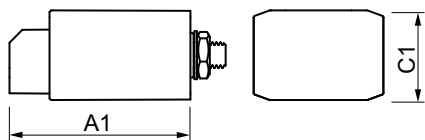
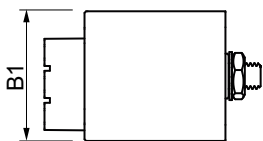

SKD 578-S 220-240V 50/60Hz

Product	A1	B1	C1
SKD 578-S 220-240V 50/60Hz	67.5 mm	40.5 mm	28.0 mm

