



HID-Basic ballasts for HPL and HPI(PLUS) lamps

BHL 250L 202

The HID-Basic ballast is an impregnated (HID standard) electromagnetic ballast for HID lamps, for use in combination with an external ignitor.

Product data

General Information	
Application code	L202
Operating and Electrical	
Input Voltage	230 V
Input frequency	50 Hz
Power factor 100% load (min.)	0.55
Mains voltage performance (AC)	-8% - +6%
Mains voltage safety (AC)	-10% - +10%
Input current with PF correction	1.35 A
Input current without PF Correction	2.13/2.15 A
Power factor without PF compensation (nom.)	0.85
Power losses (nom.)	20.4 W
Wiring	
Connector type	Screw
System characteristics	
Rated ballast-lamp power	250 W

Temperature	
T-winding (max.)	130 °C
Delta-T normal conditions	75 °C
Approval and Application	
Approval marks	CE marking
Product Data	
Full product code	871016303125530
Order product name	BHL 250L 202
EAN/UPC – product	8710163148304
Order code	03125530
SAP numerator – quantity per pack	1
SAP numerator – packs per outer box	6
Material no. (12 NC)	913710102550
SAP net weight (piece)	1.900 kg

HID-Basic ballasts for HPL and HPI(PLUS) lamps

Dimensional drawing

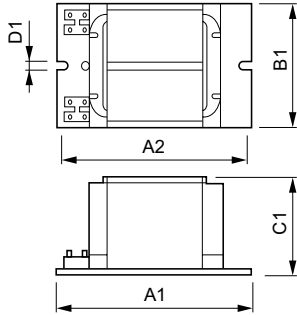

Product	D1	C1	A1	A2	B1
BHL 250L 202	6.3 mm	64.5 mm	125.0 mm	104.0 mm	72.5 mm

BHL 250 L202 230V 50Hz

