

# PHILIPS

## Lighting

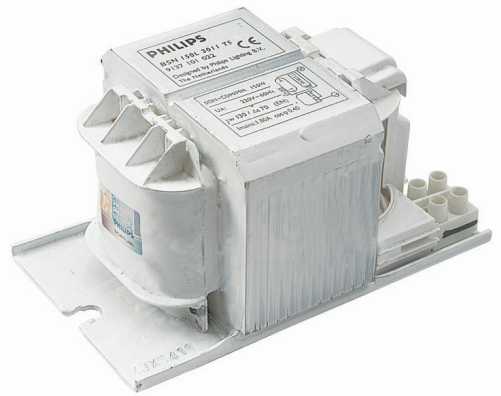

# HID-Basic ballasts for HPL and HPI(PLUS) lamps

## BHL E 400 L202

The HID-Basic ballast is an impregnated (HID standard) electromagnetic ballast for HID lamps, for use in combination with an external ignitor.

### Product data

General Information		Temperature	
Application code	L202	T-winding (max.)	130 °C
		Delta-T normal conditions	70/75 °C
Operating and Electrical		Approval and Application	
Input Voltage	230 V	Approval marks	CE marking
Input frequency	50 Hz		
Power factor 100% load (min.)	0.85	Product Data	
Mains voltage performance (AC)	-8%+6%	Full product code	872790084180000
Mains voltage safety (AC)	-10%+10%	Order product name	BHLE 400L 202
Input current with PF correction	2.15 A	EAN/UPC – product	8711500997913
Input current without PF Correction	3.25/3.4 A	Order code	84180000
Power factor without PF compensation (nom.)	0.60	SAP numerator – quantity per pack	1
Power losses (nom.)	27.5/30.5 W	SAP numerator – packs per outer box	6
Wiring		Material no. (12 NC)	913713017650
Connector type	Screw	SAP net weight (piece)	3.140 kg
System characteristics			
Rated ballast-lamp power	400 W		

## HID-Basic ballasts for HPL and HPI(PLUS) lamps

### Dimensional drawing

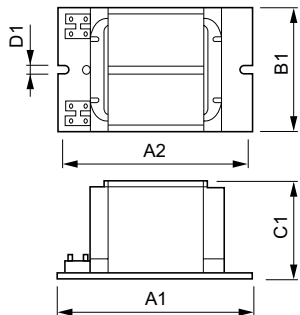

#### Product

BHLE 400L 202

BHL E 400 L202

