



HF-Selectalume II for TL5 lamps

HF-S 124/39 TL5 II 220-240V 50/60Hz

HF-Selectalume II TL5 is the most cost-effective, reliable and outstanding solution for fluorescent lamps. These ballasts are part of an overall high-efficiency lighting system that may help you or your customers to achieve any international or local energy code you need to comply with. HF-Selectalume II TL5 ballasts are the ideal choice for a broad range of new construction and retrofit applications within the commercial sector, including general surface mounting or office lighting, parking garages, warehouses, waterproof and other applications.

Product data

| General Information | | Ballast factor (nom.) | |
|---------------------------------|-------------------|---|--|
| Application code | II | | 1.05 |
| Type version | mk1 | Power losses (nom.) | 3.5/4 W |
| Lamp type | TL5 | Inrush current peak (max.) | 20 A |
| Number of lamps | 1 piece/unit | Wiring | |
| Automatic restart | Yes | Connector type input terminals | WAGO 744 connector |
| Operating and Electrical | | Cable capacity output wires mutual (max.) | 200 pF |
| Input Voltage | 220 to 240 V | Connector type output terminals | WAGO 744 connector [Suitable for manual wiring] |
| Input frequency | 50 to 60 Hz | Cable length hot-wiring | 0.75 m |
| Operating frequency (nom.) | 45 kHz | Wire strip length | 8.0-9.0 mm |
| Crest factor (nom.) | 1.7 | Dual fixture master/slave | Possible, lamp wires 2m max. length [Master/Slave operation possible] |
| Power factor 100% load (nom.) | 0.98 | Input terminal cross section | 0.50-1.50 mm ² |
| Preheat time | 1.6 s | Output terminal cross section | 0.50-1.50 mm ² |
| Mains voltage performance (AC) | 202-254V-8%-+6% | Cable capacity cold output wires – earth (max.) | 200 pF |
| Mains voltage safety (AC) | 198-264V-10%-+10% | | |
| Earth leakage current (max.) | 0.5 mA | | |
| Inrush current width | 0.28 ms | | |

HF-Selectalume II for TL5 lamps

| | |
|--|--------|
| Cable capacity hot output wires – earth (max.) | 200 pF |
|--|--------|

System characteristics

| | |
|--------------------------|-----------|
| Rated ballast-lamp power | 24/39 W |
| Rated lamp power on TL5 | 24/39 W |
| System power on TL5 | 27/42 W |
| Lamp power on TL5 | 23.5/38 W |
| Power loss on TL5 | 3.5/4 W |

Temperature

| | |
|------------------------|--------|
| T-ambient (max.) | 50 °C |
| T-ambient (min.) | -15 °C |
| T storage (max.) | 80 °C |
| T storage (min.) | -40 °C |
| T-case lifetime (nom.) | 75 °C |
| T-Case maximum (max.) | 75 °C |

Mechanical and Housing

| | |
|---------|---------------|
| Housing | L 280x30x21.5 |
|---------|---------------|

Emergency Operation

| | |
|--|--------------|
| Nominal light output after 60 seconds | 100% of EBLF |
| Normal operating voltage (DC) | 220-240 V |
| Battery voltage guaranteed operation | 176-275 V |
| Battery voltage guaranteed ignition | 186-275 V |
| Emergency ballast lumen factor (EBLF) (nom.) | 100 % |

| | |
|--------------------------------------|-------------|
| Nominal light output after 5 seconds | 50% of EBLF |
|--------------------------------------|-------------|

Approval and Application

| | |
|-------------------------|---|
| Energy efficiency index | A2/A2BAT |
| IP classification | IP 20 [Ingress Protection 20] |
| EMI 9 kHz ... 30 MHz | EN55015 |
| Vibration standard | IEC68-2-6 F c |
| Bumps standard | IEC 68-2-29 Eb (10G/16ms) |
| Approval marks | F-Marking CE marking ENEC certificate CCC certificate C-Tick certificate PSB certification TISI marking SIRIM approval CB Certificate CCC certificate VDE-EMV certificate |
| Humming and noise level | < 30 dB(A) |

Product Data

| | |
|-----------------------------------|-------------------------------------|
| Full product code | 872790093933000 |
| Order product name | HF-S 124-39 TL5 II 220-240V 50/60Hz |
| EAN/UPC – product | 8727900939330 |
| Order code | 93933000 |
| SAP numerator – quantity per pack | 1 |
| Numerator – packs per outer box | 12 |
| Material no. (12 NC) | 913713034466 |
| Net Weight (Piece) | 0.190 kg |

Dimensional drawing

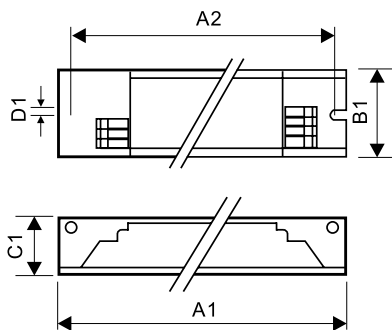

HF-S 124-39 TL5 II 220-240V 50/60Hz

Product

HF-S 124-39 TL5 II 220-240V 50/60Hz

HF-Selectalume II for TL5 lamps

